

PLACA GUIA DE ACERO (HARDENED STEEL WEAR PLATE)

5124

MATERIAL: Acero de cementación
DUREZA: 62 ± 2 HRc
PROF. DE CEMENTACIÓN: 0,8 - 1,2 mm.
FORMA DE PEDIDO: 5124 - W x L

MATERIAL: Hardened Steel
HARDNESS: 62 ± 2 HRc
HARDENED DEEP: 0.8 - 1.2 mm.
HOW TO ORDER: 5124 - W x L

REFERENCIA	W	L	a	b	Tipo Type
5124 - 28 x 75	28	75	-	45	B
5124 - 28 x 100		100		50	
5124 - 28 x 125		125		75	
5124 - 28 x 150		150		100	
5124 - 28 x 200		200		150	
5124 - 38 x 75	38	75	-	45	
5124 - 38 x 100		100		50	
5124 - 38 x 125		125		75	
5124 - 38 x 150		150		100	
5124 - 38 x 200		200		150	
5124 - 48 x 75	48	75	-	45	
5124 - 48 x 100		100		50	
5124 - 48 x 125		125		75	
5124 - 48 x 150		150		100	
5124 - 48 x 200		200		150	
5124 - 58 x 75	58	75	-	45	
5124 - 58 x 100		100		50	
5124 - 58 x 150		150		100	
5124 - 75 x 75	75	75	25	25	A
5124 - 75 x 100		100	25	50	A
5124 - 75 x 125		125	-	75	B
5124 - 75 x 150		150		100	
5124 - 75 x 200		200		150	
5124 - 100 x 100	100	100	50	50	C
5124 - 100 x 125		125		75	
5124 - 100 x 150		150		100	
5124 - 100 x 200		200		150	
5124 - 100 x 250		250		200	
5124 - 125 x 125	125	125	50	75	
5124 - 125 x 150		150		100	
5124 - 125 x 200		200		150	
5124 - 125 x 250		250		200	
5124 - 150 x 150	150	150	100	100	
5124 - 150 x 200		200		150	
5124 - 150 x 250		250		200	
5124 - 150 x 300		300		250	

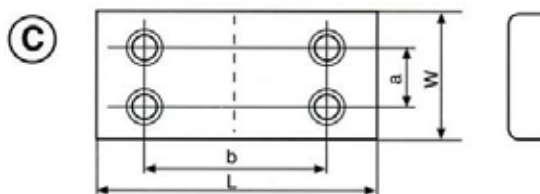
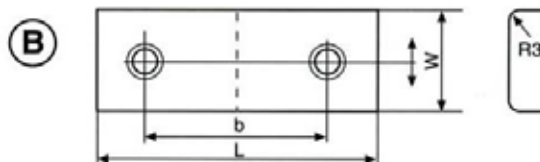
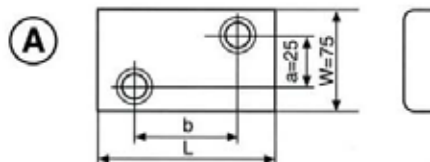

Tornillos: M10 / Screws: M10

